

TAG	WIDTH	HGT.	QTY.	NOTES
A	2'-0"	3'-0"	3	FIXED GLASS
B	2'-0"	3'-0"	1	CASEMENT
C	3'-0"	6'-0"	11	CASEMENT
D	3'-0"	6'-0"	7	FIXED GLASS
E	4'-0"	6'-0"	2	FIXED GLASS
F	8'-0"	4'-0"	1	FIXED GLASS
G	7'-0"	10'-0"	2	FIXED GLASS
H	2'-4"	10'-0"	1	FIXED GLASS
I	3'-0"	4'-0"	1	CASEMENT
J	4'-0"	6'-0"	3	DOUBLE CASEMENT
K	2'-0"	6'-0"	1	CASEMENT
L	6'-0"	6'-0"	1	FIXED GLASS
M	5'-0"	5'-0"	1	HORIZONTAL ROLLER
N	3'-0"	10'-0"	2	FIXED GLASS
O	6'-0"	10'-0"	1	FIXED GLASS
P	3'-0"	8'-0"	2	FIXED GLASS
Q	6'-0"	8'-0"	1	FIXED GLASS
R	8'-8"	8'-0"	1	FIXED GLASS
S	3'-0"	3'-0"	1	FIXED GLASS
T	7'-0"	9'-4"	2	FIXED GLASS

TAG	WIDTH	HGT.	QTY.	NOTES
1	4'-0"	10'-0"	1	GLASS ENTRY DOOR
2	3'-0"	8'-0"	5	FULL GLASS
3	3'-0"	8'-0"	2	SOLID DOOR T.B.D.
4	1'8"-0"	8'-0"	2	OHGD
5	1'2"-0"	8'-0"	1	(3) PANEL SLIDING GLASS DOOR
6	8'-0"	8'-0"	1	(2) PANEL SLIDING GLASS DOOR
7	5'-8"	8'-6"	1	SOLID ENTRY GATE

TAG	WIDTH	HGT.	QTY.	NOTES
8	3'-0"	8'-0"	1	20 MIN. RATED OR SOLID CORE
9	3'-0"	8'-0"	7	SWING
10	2'-8"	8'-0"	8	SWING
11	2'-6"	8'-0"	2	SWING
12	4'-0"	8'-0"	1	DOUBLE SWING
13	3'-0"	8'-0"	2	POCKET
14	2'-8"	8'-0"	1	POCKET
15	8'-0"	8'-0"	1	SLIDING BI-PASS SCREENS
16	5'-0"	8'-0"	1	SLIDING BI-PASS SCREENS
17	5'-0"	8'-0"	1	BI-PASS
18	3'-0"	8'-0"	1	BI-FOLD
19	4'-0"	8'-0"	1	DOUBLE BI-FOLD

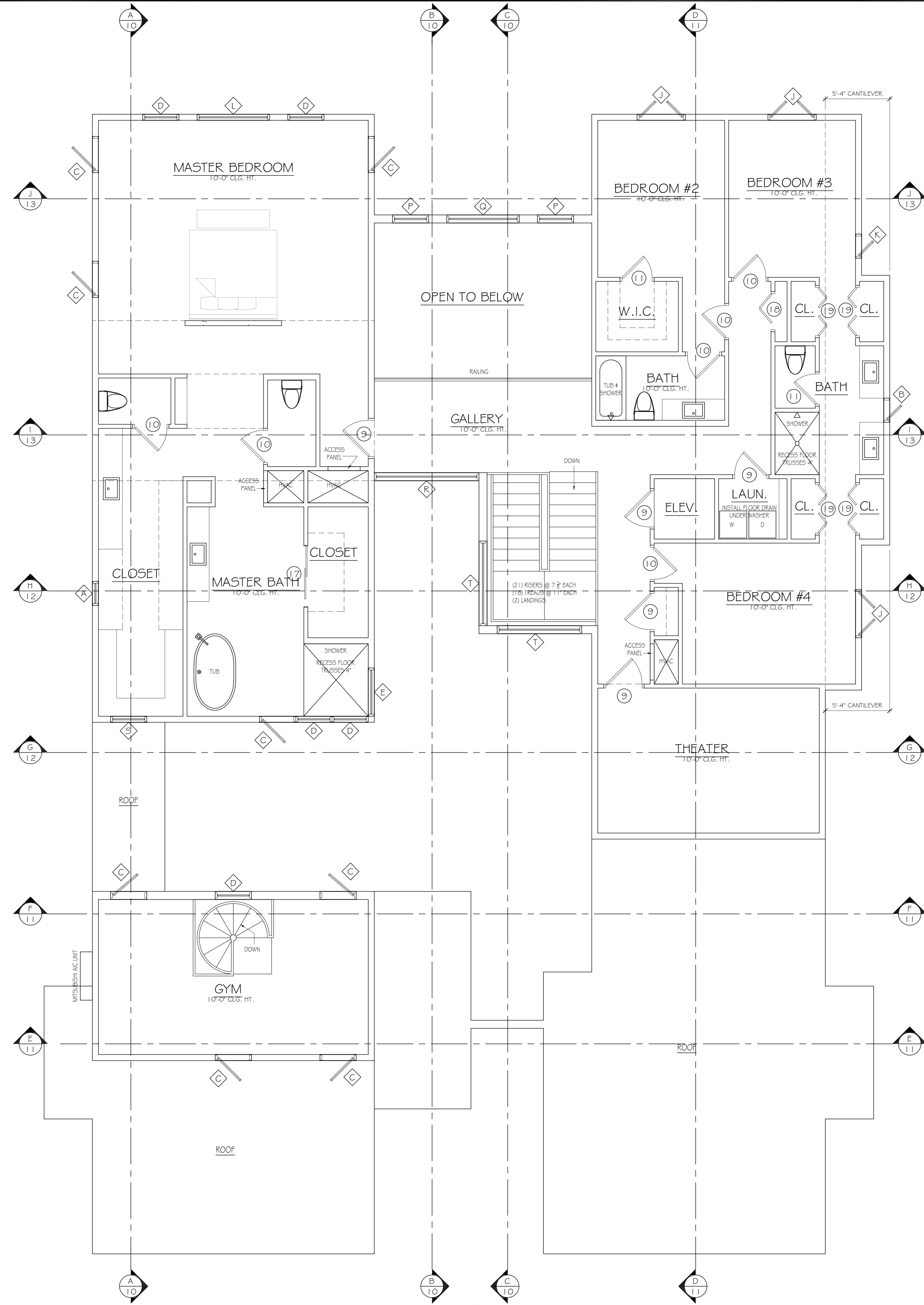

UPPER LEVEL FLOOR PLAN - NOTED
SCALE: 1/4" = 1'-0"

City of Ormond Beach
REVIEWED FOR
CODE COMPLIANCE
*This does not grant permission to violate any applicable law, code or ordinance.
BP19-00003561
Stamped By: Roxanne Deknatel
07/17/19 04:43 PM

JAMES C. LUCIA
RESIDENTIAL DESIGN
jucia@ucddesigns.com

CUSTOM DESIGN FOR THE:
DESAI RESIDENCE
380 RIVERSIDE DRIVE
ORMOND BEACH, FL 32176
DATE: 03-26-2019
SCALE: NOTED
DRAWN: EML
JOB:
SHEET 5
OF 5 SHEETS